

Note: Part numbers enclosed in brackets ( ) are not available individually, but may be sold in assemblies or kits.

EAGLE 950 INTERNAL ASSEMBLY

Ref.	Part Description	Qty.	950-E	950-S	950-H
<b>SNAP RINGS</b>					
1	Snap Cover (all models)	1	211934-01	211934-01	211934-01
2A	Rubber Cover, Snap Ring	See Rubber Cover Kit at Right			
2B	Snap Ring, Upper	See Rubber Cover Kit at Right			

Ref.	Part Description	Qty.	950-E	950-S	950-H
<b>INTERNAL ASSEMBLY</b>					
3	Internal Assembly (C, D)	1	211442-xx	211919-xx	211442-xx

Ref.	Part Description	Qty.	950-E	950-S	950-H
<b>COVER ASSEMBLY</b>					
4	Screw, Self-Tapping #1/4 - 15	2	210975	210975	210975
-	One Piece Arc Adjust Kit (A)	1	212893	212893	212893
-	NP One Piece Arc Adjust Kit (A)	1	212893-09S	212893-09S	212893-09S
5	Cover, Housing (on & after 11/06) (A)	1	212820	212820	212820
7	O-Ring, Screw	2	209778	209778	209778

Ref.	Part Description	Qty.	950-E	950-S	950-H
<b>NOZZLES</b>					
8	Housing, Nozzle-Black(on & after 11/06)(A)	1	212822-01	212822-01	212822-01
8	Housing, Nozzle-Purple(on & after 11/06)(A)	1	212822-09	212822-09	212822-09
-	Nozzle/Stator Kit - Cascade (C)	1	211441-xx	211441-xx	211441-xx
-	Nozzle/Stator Kit - Non-Cascade (D)	1	211215-xx	211215-xx	211215-xx
9	Nozzle Assembly, Range	1	-	-	-
17	Poppet	1	-	-	-
18	Stator(F)	1	210057	210057	210057
10	Seal, Retract	1	210231	210231	210231
19	Screen	1	210232	210232	210232

Ref.	Part Description	Qty.	950-E	950-S	950-H
<b>BEARING / RISER-MOTOR ASSEMBLY</b>					
11	O-Ring, Nozzle Housing	1	210436	210436	210436
12	Adjustment Stem (on & after 11/06) (A)	1	212946S	212946S	212946S
12B	O-Ring, AS-009 70A, EPDM 950	1	212851	212851	212851
12C	O-Ring Seal	1	211421R	211421R	211421R
13	Guide, Bearing Assy, STD	1	211460	-	211460
13	Guide, Bearing Kit, LO-FLOW (E)	1	-	211461	-
14	O-Ring, Bearing Guide	1	212383	212383	212383
15	Spring, Retract	1	209783	209783	209783
16	Riser Motor Assembly	1	210439	210439	210439
16A	Nozzle Base Replacement Kit w/seals	1	212061	212061	212061
16B	Pop-up Seal (White)	1	209781	209781	209781

20 CASE ASSEMBLY See Catalog No. 466

- (A) One Piece Arc Adjust incorporated 11/06. Prior to 11/06, order kit #212893. Upgrade to the One Piece Arc Adjust Kit.
- (C) Specify Nozzle Size when ordering. Available in # 18, 20, 22, 24.
- (D) Specify Nozzle Size when ordering. Available in # 26, 28, 30, 32.
- (E) The LO-FLOW Bearing Guide #211461 may also be used on the 950 Series Electric and Hydraulic rotors.
- (F) Add Spacer #212338 to #28 nozzle (set at 80 or 100 psi) and #30, #32 nozzles (all pressures).

Ref.	KITS & Accessories	Qty.	P/N
1	Snap-Cover, Yellow	1	211934-02
1	Snap-Cover, White	1	211934-03
1	Snap-Cover, Purple (Non-Potable)	1	211934-04

Ref.	Part Description	Qty.	P/N
<b>Rubber Cover Kit</b> 212554			
2A	Rubber Cover, Snap Ring	1	
2B	Snap Ring, Upper	1	(211133-01)
5	Rubber Cover, Housing	1	
-	Rubber Case Cover	1	

5	Cover, Yardage Marker Blank (White) (A)	1	212141-03
5	Cover, Yardage Marker Blank (Black) (A)	1	212141-01
5	Cover, Housing	1	
6	Oversized Arc Adjust (A)	1	
6A	Quad Seal, Arc Adjust	1	

Ref.	Part Description	Qty.	P/N
<b>Diffuser Screw Kit</b> 212145			
8	Nozzle Housing, Drilled & Tapped	1	
-	Diffuser Screws	2	
5	Cover, Notched	1	
10	Retract Seal	1	
7	O-Ring, Screw	2	

<b>EAGLE's TAIL KIT (Black)</b> 211900			
<b>EAGLE's TAIL KIT (Purple)</b> 211901			
8	Housing, Nozzle, Drilled in back	1	
-	Close-in Spreader Nozzle, 700	1	211452
5	Cover, Housing	1	
10	Retract Seal	1	
7	O-Ring, Screw	2	
EAGLE's Tail Instruction Sheet 1			

**Stator / Poppet Configurations - Cascade & Non-Cascade**

Color	Number	Electric Pressure Setting				Hyd, SAM, B
		psi (bars)				
		60 (4,1)	70 (4,8)	80 (5,5)	100 (6,9)	
White	#18C	SPC	SPC	SPC	SPC	SPC
Gray	#20C	SPC	SPC	SPC	SPC	SPC
Blue	#22C	SPC	SPC	SPC	SPC	SPC
Yellow	#24C	SPC	SPC	SPO	SPO	SPO
Orange	#26	SPO	SPO	SPO	SPO	SPO
Green	#28	N/R	SNP	SPR	SPR	SPR
Black	#30	N/R	SNP	SPR	SPR	SPR
Brown	#32	N/R	N/R	SPR	SPR	SPR

SPC = Stator with Poppet Closed      SPR = Spacer and Screen  
 SPO = Stator with Poppet Open      N/R=Not a Recommended Pressure and Nozzle Setting  
 SNP = Stator No Poppet

Stator with Poppet Closed

Stator with Poppet Open

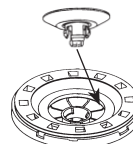

Should be tight when snapped in

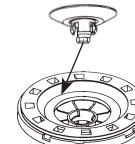

Should be loose when snapped in

Note: Part numbers enclosed in brackets ( ) are not available individually, but may be sold in assemblies or kits.